

APR 12 2021

**Approved**

**REQUEST FOR AGENDA PLACEMENT FORM**

**Submission Deadline - Tuesday, 12:00 PM before Court Dates**

**SUBMITTED BY:** Patty Bourgeois

**TODAY'S DATE:** 4-6-21

**DEPARTMENT:**

X Elections

**SIGNATURE OF DEPARTMENT HEAD:**

X *Patty Bourgeois*

**REQUESTED AGENDA DATE:**

X 4-12-2021

**SPECIFIC AGENDA WORDING:** Consideration to approve the New Voting Precinct lines due to population increase. New Precincts will be 37, 38, 39, 40, 41, 42.

**PERSON(S) TO PRESENT ITEM:** Patty Bourgeois

**SUPPORT MATERIAL: (Must enclose supporting documentation)**

**TIME:** 5

**ACTION ITEM:** \_\_\_\_\_

**WORKSHOP:** X

(Anticipated number of minutes needed to discuss item) **CONSENT:** \_\_\_\_\_

**EXECUTIVE:** \_\_\_\_\_

**STAFF NOTICE:**

**COUNTY ATTORNEY:** \_\_\_\_\_

**ISS DEPARTMENT:** \_\_\_\_\_

**AUDITOR:** \_\_\_\_\_

**PURCHASING DEPARTMENT:** \_\_\_\_\_

**PERSONNEL:** \_\_\_\_\_

**PUBLIC WORKS:** \_\_\_\_\_

**BUDGET COORDINATOR:** \_\_\_\_\_

**OTHER:** \_\_\_\_\_

\*\*\*\*\*This Section to be Completed by County Judge's Office\*\*\*\*\*

ASSIGNED AGENDA DATE: \_\_\_\_\_

REQUEST RECEIVED BY COUNTY JUDGE'S OFFICE \_\_\_\_\_

COURT MEMBER APPROVAL \_\_\_\_\_ Date \_\_\_\_\_

# NEW VOTING PRECINCT LINES DUE TO POPULATION INCREASE

## Pct. 2 & 38

The new Precinct line would follow FM 1902 to create Pct. 38.

Current Registered Voters in Pct. 2 ≈6028

After the split:

Registered Voters Pct. 2 ≈3541

Registered Voters Pct. 38 ≈2487

Pct. 2 - New Rd. Line

Pct. 38

Pct. 2

Pct. 38

31

31

32

2

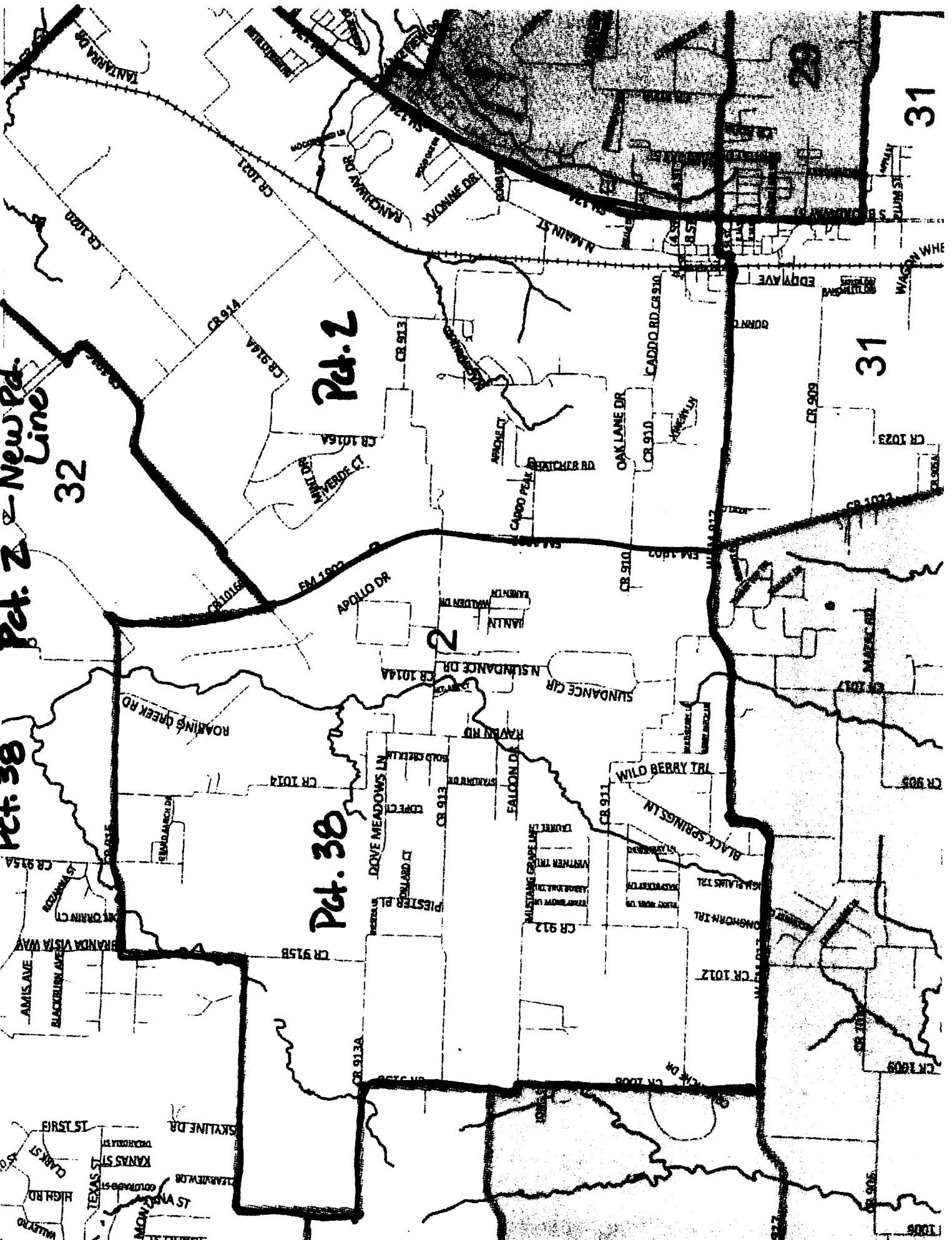

# NEW VOTING PRECINCT LINES DUE TO POPULATION INCREASE

## Pct. 3 & 39

The new Precinct line would follow NW John Jones to create Pct. 39.

Current Registered Voters in Pct. 3 ≈4657

After the split:

Registered Voters Pct. 3 ≈2415

Registered Voters Pct. 39 ≈2242

Pct. 39

Pct. 3

- New Pct. Line

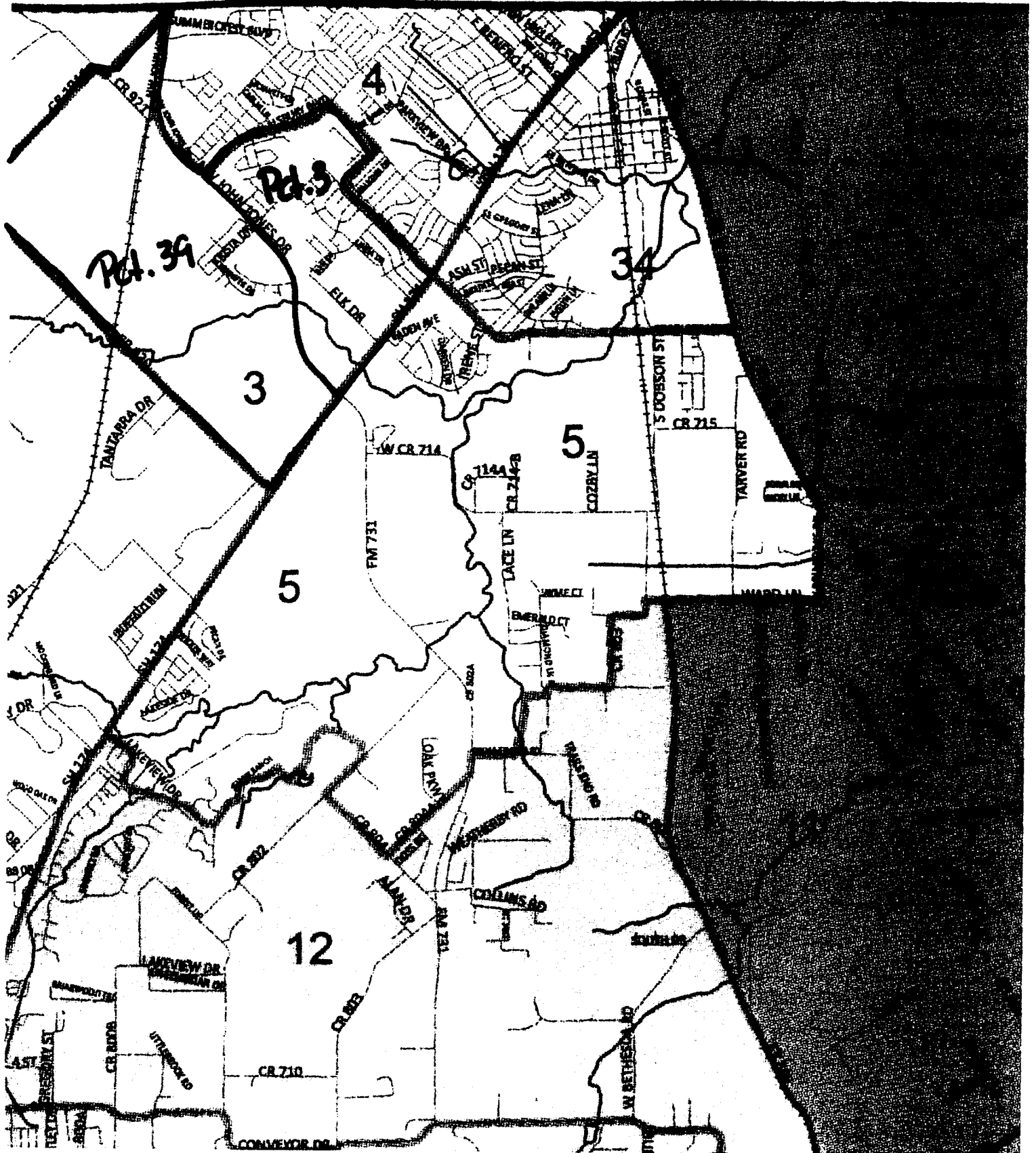

# NEW VOTING PRECINCT LINES DUE TO POPULATION INCREASE

## Pct. 4 & 40

The new Precinct line would follow SW Alsbury to create Pct. 40.

Current Registered Voters in Pct. 4 ≈6940

After the split:

Registered Voters Pct. 4 ≈3952

Registered Voters Pct. 40 ≈2988



# NEW VOTING PRECINCT LINES DUE TO POPULATION INCREASE

## Pct. 7 & 41

The new Precinct line would follow Renfro St. to create Pct. 41.

Current Registered Voters in Pct. 7 ≈6441

After the split:

Registered Voters Pct. 7 ≈2917

Registered Voters Pct. 41 ≈3524



Pct. 41

Pct. 7

- New Pct. Line

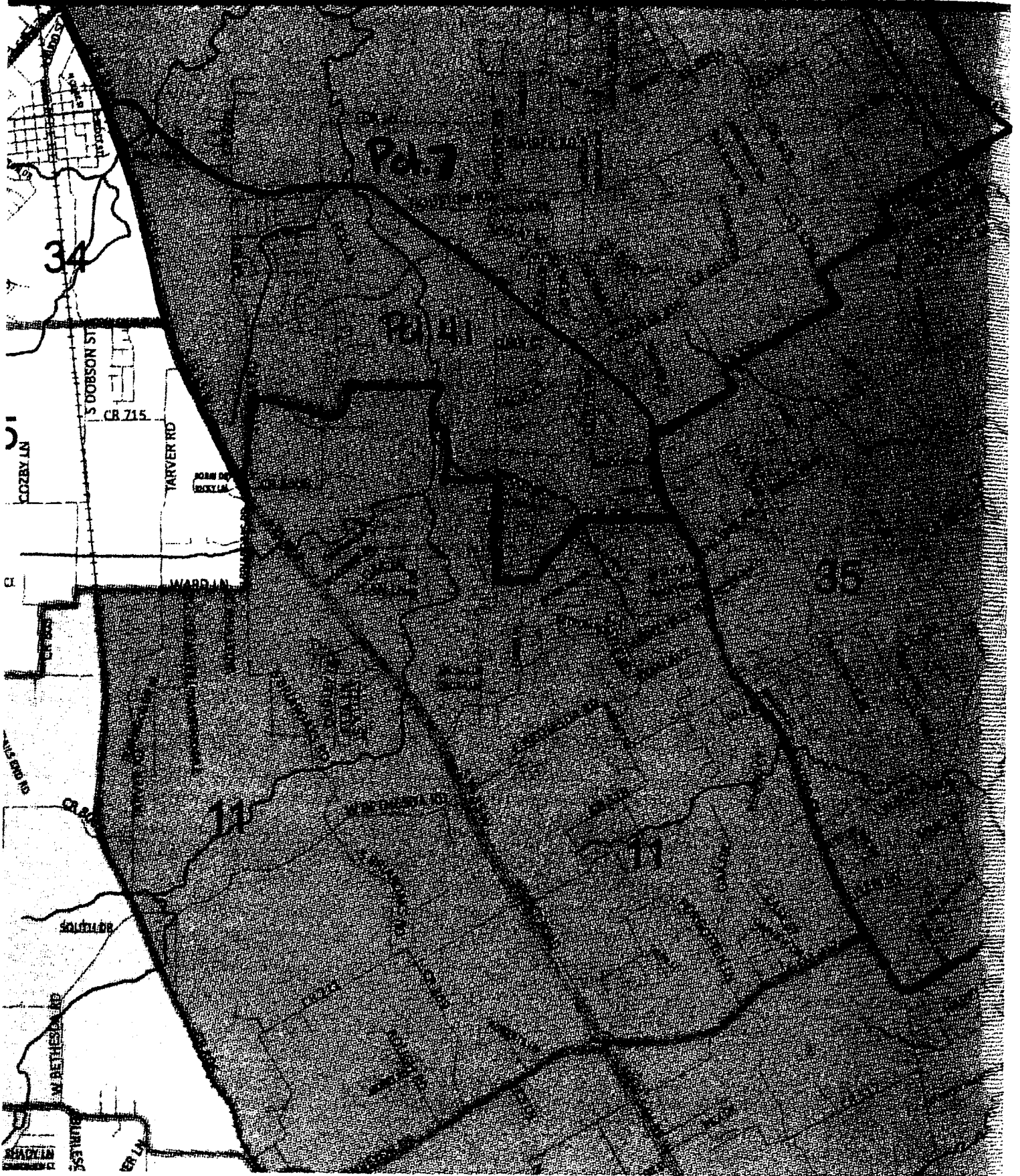

# NEW VOTING PRECINCT LINES DUE TO POPULATION INCREASE

## Pct. 8 & 42

The new Precinct line would follow FM 157, CR 502, & CR 620 to create Pct. 42.

Current Registered Voters in Pct. 8 ≈8937

After the split:

Registered Voters Pct. 8 ≈4361

Registered Voters Pct. 42 ≈4576

Pct. 8

Pct. 42

- New Pct. Line



# NEW VOTING PRECINCT LINES DUE TO POPULATION INCREASE

## Pct. 19 & 37

The new Precinct line would follow Hyde Park to create Pct. 37.

Current Registered Voters in Pct. 19 ≈6021

After the split:

Registered Voters Pct. 19 ≈3610

Registered Voters Pct. 37 ≈2411

